

CRESTWOOD SQUARE ROYAL PALM BEACH, FL

11977 Southern Boulevard, Royal Palm Beach, FL 33411

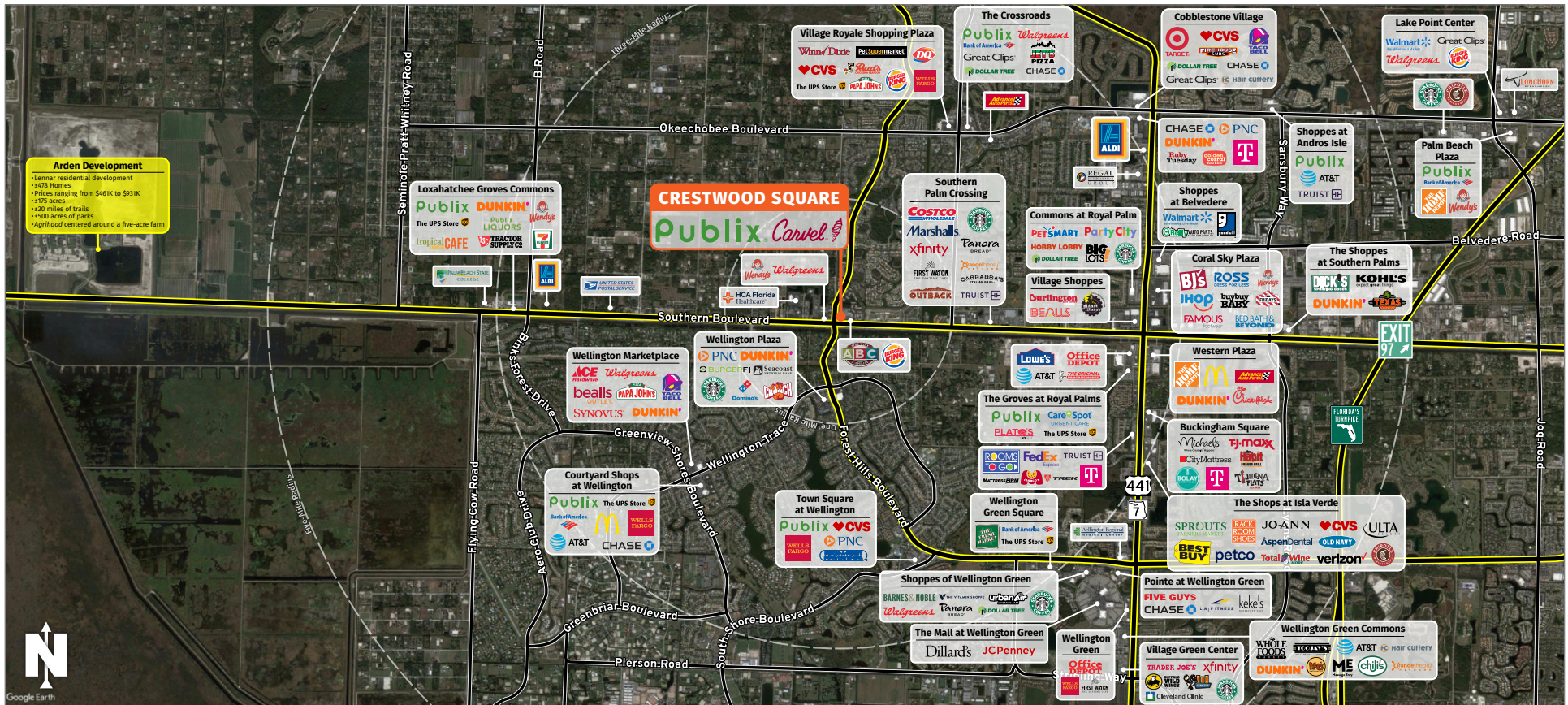

MARKET: South Florida

COUNTY: Palm Beach

GLA: ±78,405 SF

TRAFFIC COUNT: ±72,000

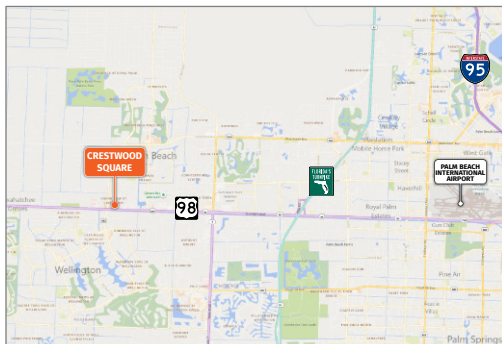

- Crestwood Square is a ±78,405-square-foot shopping center located on the northeast corner of Southern Boulevard and Crestwood Boulevard.
- The center is situated in the Village of Royal Palm Beach, adjacent to the affluent community of Wellington.
- Crestwood Square is anchored by a ±51,420-square-foot, high-volume Publix Super Market.
- Other notable tenants in the center include Duffy's Sport's Bar and Carvel Ice Cream.

MEREDITH VOGEL | LEASING AGENT

mvogel@secenters.com

(561) 347-0888 | Mobile (561) 420-9718

SOUTHEAST CENTERS

WWW.SOUTHEASTCENTERS.COM



MEREDITH VOGEL | LEASING AGENT
mvogel@secenters.com
(561) 347-0888 | Mobile (561) 420-9718

CRESTWOOD SQUARE
11977 Southern Boulevard, Royal Palm Beach, FL 33411

SOUTHEAST
CENTERS

CRESTWOOD SQUARE

TENANTS	UNIT	SIZE
Goodwill	1	1,300 SF
Sal's Italian Restaurant	2-3	1,950 SF
F&R Hair Salon	4	975 SF
Dr. Farokh Jiveh, DDS	5	1,300 SF
Postal and Global Services	6	975 SF
Available	7	1,300 SF
Publix Super Markets	8	51,420 SF
Reliant Realty	9	1,300 SF
Nail Salon	10-11	1,950 SF
China Hut	12	975 SF
Available	13	1,471 SF
Pho 16	14	1,454 SF
Carvel Ice Cream	15	1,300 SF
LOI Insurance	16	975 SF
Available	17	1,300 SF
Available	18-19	2,100 SF
Smart Laundry	20	900 SF
Duffy's Sports Bar	21	5,460 SF

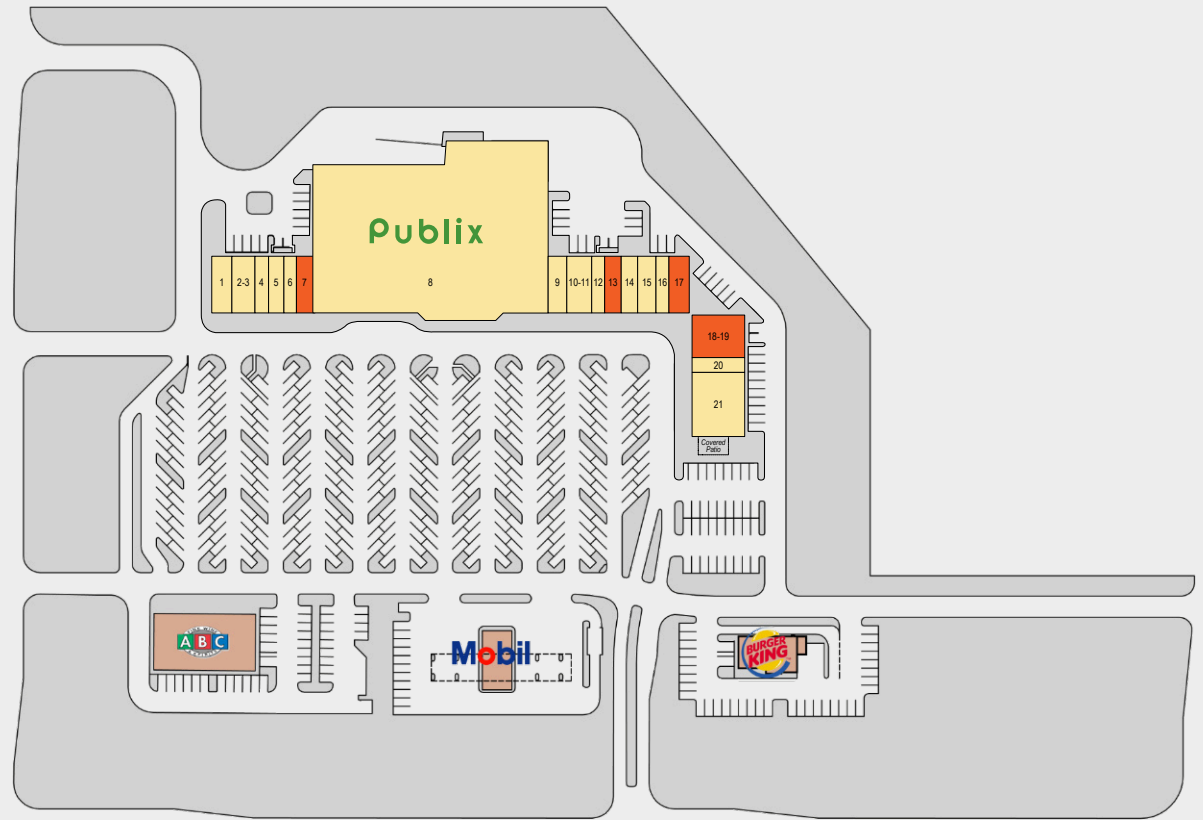

11977 Southern Boulevard, Royal Palm Beach, FL 33411



DEMOGRAPHICS	TOTAL POPULATION	MEDIAN AGE	AVERAGE HH INCOME
1 MILE	8,413	43.2	\$96,808
3 MILES	69,695	40.3	\$105,722
5 MILES	127,541	41.0	\$112,192

Southeast Centers offers best-in-class service and value creation through diligent, return-driven property management, leasing, development, and construction management.



This site plan shows the approximate location, square footage, and configuration of the shopping center and adjacent areas, and is only illustrative of the size and relationship of the stores and common areas generally, all of which are subject to change. The showing of any names of tenants, parking spaces, square footage, curb-cuts or traffic controls shall not be deemed to be a representation or warranty that any tenants will be at the shopping center, the square footage is accurate, or that any parking spaces, curb-cuts or traffic controls do or will continue to exist. Moreover, any demographics set forth in this flyer are for illustrative purposes only and shall not be deemed a representation by Landlord or their accuracy.