

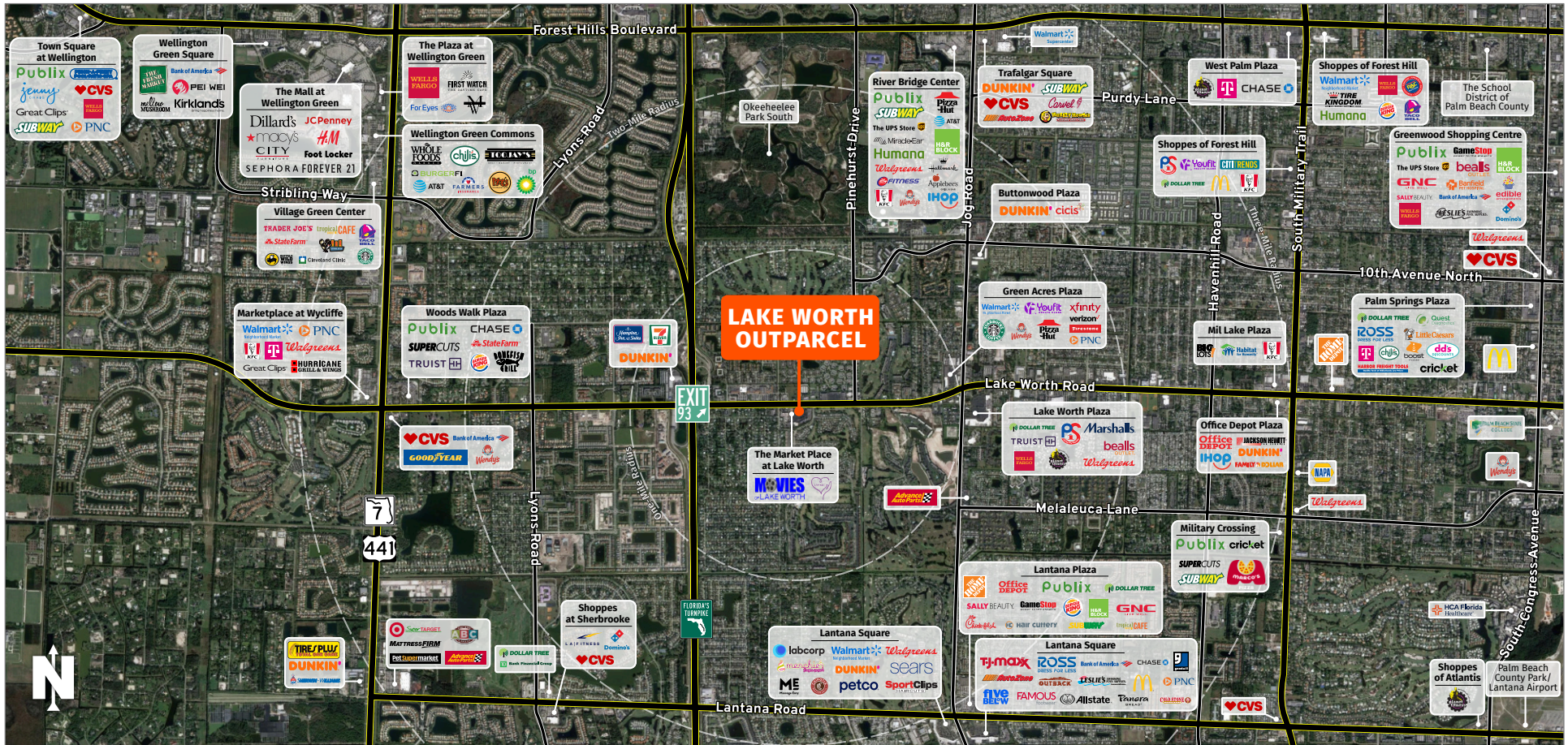

LAKE WORTH OUTPARCEL

7300 Lake Worth Road, Lake Worth, Florida 33467

LAKE WORTH, FL



**LAKE WORTH
OUTPARCEL**

MARKET: South Florida **COUNTY:** Palm Beach **Land Area:** ±0.80 Acres **Building Size:** ±2,400 SF **Zoning:** CG **TRAFFIC COUNT:** ±47,059



- ±2,400-square-foot former bank building with drive-through available for lease
- Located on ±0.80 acres in front of The Market Place at Lake Worth with excellent exposure to the highly-trafficked Lake Worth Road, less than one mile from Florida's Turnpike
- Ideal for restaurants seeking drive-throughs
- Built-to-suit, land lease or redevelopment opportunities available

MEREDITH VOGEL | LEASING AGENT

mvogel@secenters.com

(561) 347-0888 | Mobile (561) 420-9718



WWW.SOUTHEASTCENTERS.COM



MEREDITH VOGEL | LEASING AGENT
mvogel@secenters.com
(561) 347-0888 | Mobile (561) 420-9718

LAKE WORTH OUTPARCEL
7300 Lake Worth Road, Lake Worth, Florida 33467

SOUTHEAST
CENTERS

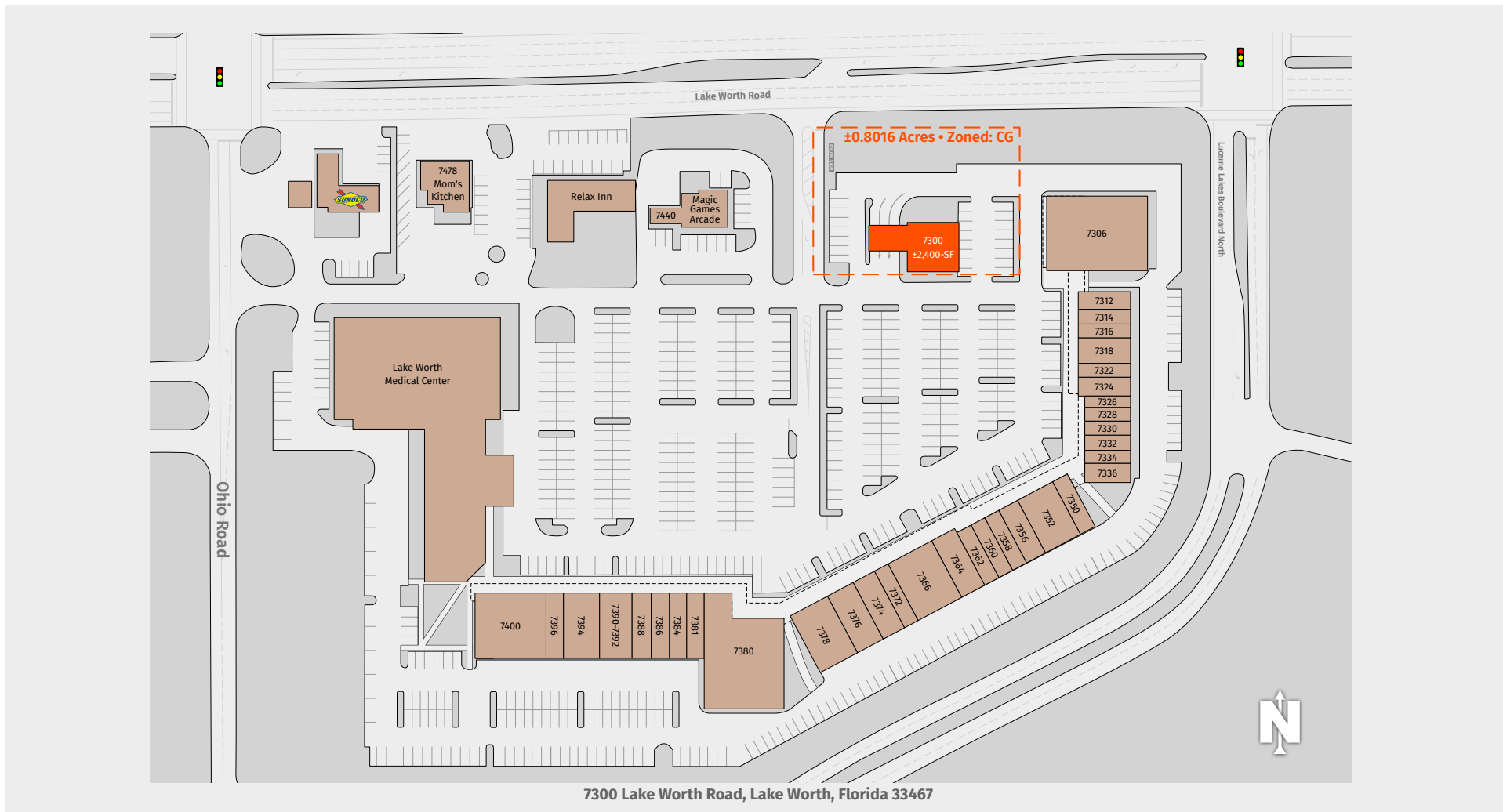

DEMOGRAPHICS	TOTAL POPULATION	MEDIAN AGE	AVERAGE HH INCOME
1 MILE	13,129	43.9	\$75,859
3 MILES	118,981	42.9	\$109,322
5 MILES	288,345	43.3	\$116,754

Southeast Centers offers best-in-class service and value creation through diligent, return-driven property management, leasing, development, and construction management.



This site plan shows the approximate location, square footage, and configuration of the shopping center and adjacent areas, and is only illustrative of the size and relationship of the stores and common areas generally, all of which are subject to change. The showing of any names of tenants, parking spaces, square footage, curb-cuts or traffic controls shall not be deemed to be a representation or warranty that any tenants will be at the shopping center, the square footage is accurate, or that any parking spaces, curb-cuts or traffic controls do or will continue to exist. Moreover, any demographics set forth in this flyer are for illustrative purposes only and shall not be deemed a representation by Landlord or their accuracy.