



TOWN CENTER AT ORANGE LAKE

14928 East Orange Lake Boulevard, Kissimmee, FL 34747



MARKET: Central Florida

COUNTY: Orange

GLA: 56,775 SF

TRAFFIC COUNT: 65,000



	TOTAL POPULATION	MEDIAN AGE	AVG. HH INCOME
1 MILE	2,195	35.7	\$71,956
3 MILES	7,734	36.8	\$68,657
5 MILES	30,657	39.6	\$71,579

JASON REISMAN | LEASING AGENT

jreisman@secenters.com

(321) 677-0155 | Mobile (561) 445-5571



WWW.SOUTHEASTCENTERS.COM

TOWN CENTER AT ORANGE LAKE

TENANTS	UNIT	SF
China Star Restaurant	A-1	1,320
T-Mobile	A-2	1,320
Orange County Fire Dept.	A-3-4	2,220
Publix	A-B	47,955
Millenia Day Spa	B-1	900
1001 Liquors	B-2	1,020
Pak Mail	B-3	1,020
Orange Lake Cleaners	B-4	1,020

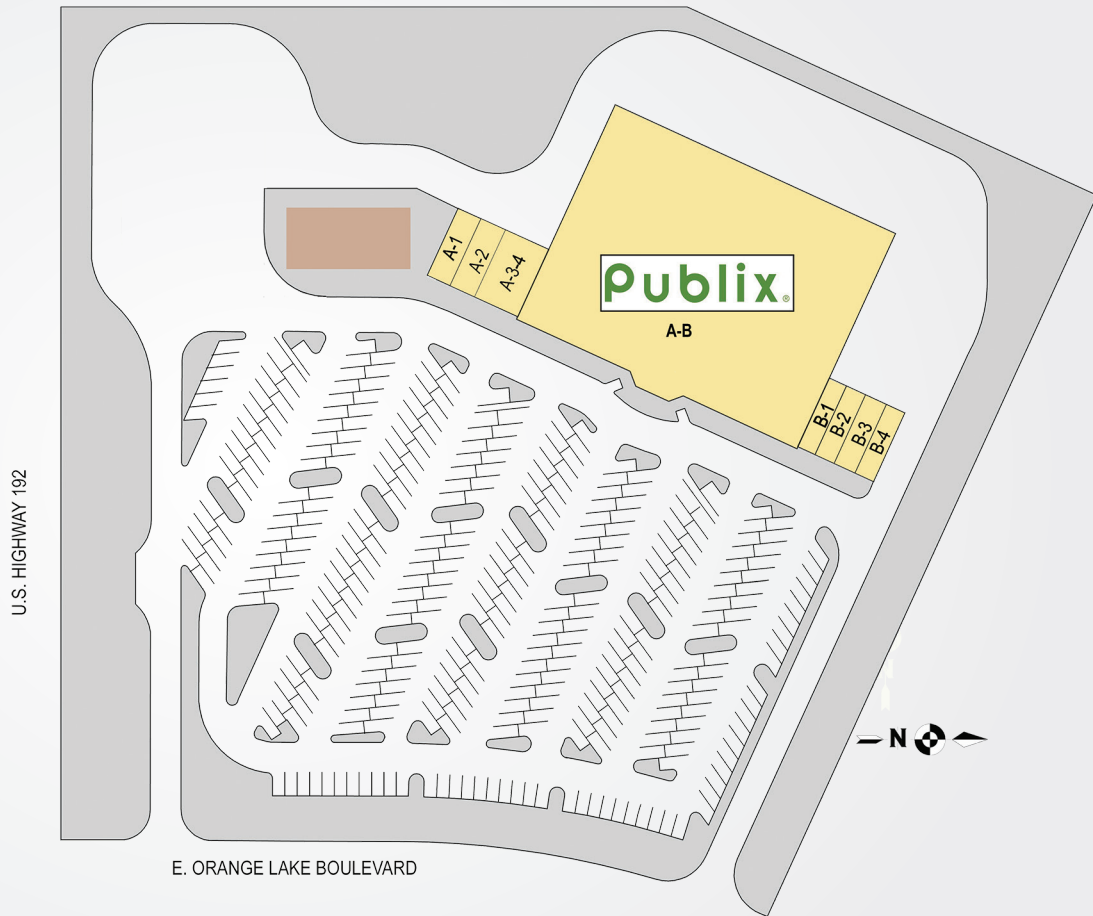

14928 East Orange Lake Boulevard, Kissimmee, FL 34747

Town Center at Orange Lake is a Publix-anchored center located on the north side US HWY 192, just east of the Western Beltway (SR 429). The plaza sits at the entrance to the Orange Lake Resort – a 1,450-acre flagship resort built around providing fun for the whole family and located right next door to Disney’s Animal Kingdom Theme Park. In addition, Rolling Oaks Commons is located on the south side of US-192, with anchors including SuperTarget, Ross, and TJ Maxx, as is the \$750 million, 300-acre Margaritaville Resort and waterpark, which is currently under construction with the 1st phase set to be completed in 2018. The Daily traffic counts on US-192 average 65,000+ vehicles per day.

Best-in-class service and value creation through diligent, return-driven property management, leasing, development, and construction management



This site plan shows the approximate location, square footage, and configuration of the shopping center and adjacent areas, and is only illustrative of the size and relationship of the stores and common areas generally, all of which are subject to change. The showing of any names of tenants, parking spaces, square footage, curb-cuts or traffic controls shall not be deemed to be a representation or warranty that any tenants will be at the shopping center, the square footage is accurate, or that any parking spaces, curb-cuts or traffic controls do or will continue to exist. Moreover, any demographics set forth in this flyer are for illustrative purposes only and shall not be deemed a representation by Landlord or their accuracy.